

**LAND CERTIFICATE NO. 49036 COPY**

Land Certificate No. 49036 Tulcea

**A. Part I. Property description LAND**

within the built-up area

Address: Loc. Tulcea, Str CONCORDIEI, Jud. Tulcea

Item no.	Cadastral number Topographic number	Surface* (sqm)	Observations / References
A1	49036	3,030	Unfenced land; Land delimited by concrete fence, metal fence, wooden fence and conventional border. Public domain

**B. Part II. Owners and documents**

Entries regarding property rights and other real rights		References
59333 / 23/06/2021		
Administrative Act no. 80, dated 31/03/2021 issued by the Local Council of Tulcea Municipality; Administrative Act no. 59, dated 25/02/2021 issued by the Local Council of Tulcea Municipality; Administrative Act no. 8134, dated 02/06/2021 issued by the Tulcea City Hall;		
B1	Tabulation, PROPERTY right, acquired by law, current share 1/1, initial share 1/1	A1
	1) TULCEA MUNICIPALITY, CIF (Fiscal Identification Code): 4321429, public domain	
86970 / 17/09/2021		
Administrative Act no. 59333, dated 23/06/2021 issued by OCPI Tulcea;		
B2	It is noted the repositioning of the building according to the location and delimitation plan of the building with coordinate inventory confirmed by OCPI Tulcea on 23.09.2021	A1

**C. Part III. ENCUMBRANCES.**

Entries regarding dismemberment of property rights, real rights of guarantee and encumbrances	References
NOT EXISTING	

## Annex No. 1 To Part I

## Land

Cadastral no.	Surface (sqm)*	Observations / References
49036	3,030	Land delimited by concrete fence, metal fence, wooden fence and conventional border. Public domain

\* The surface is determined in the Stereo 70 projection plane.

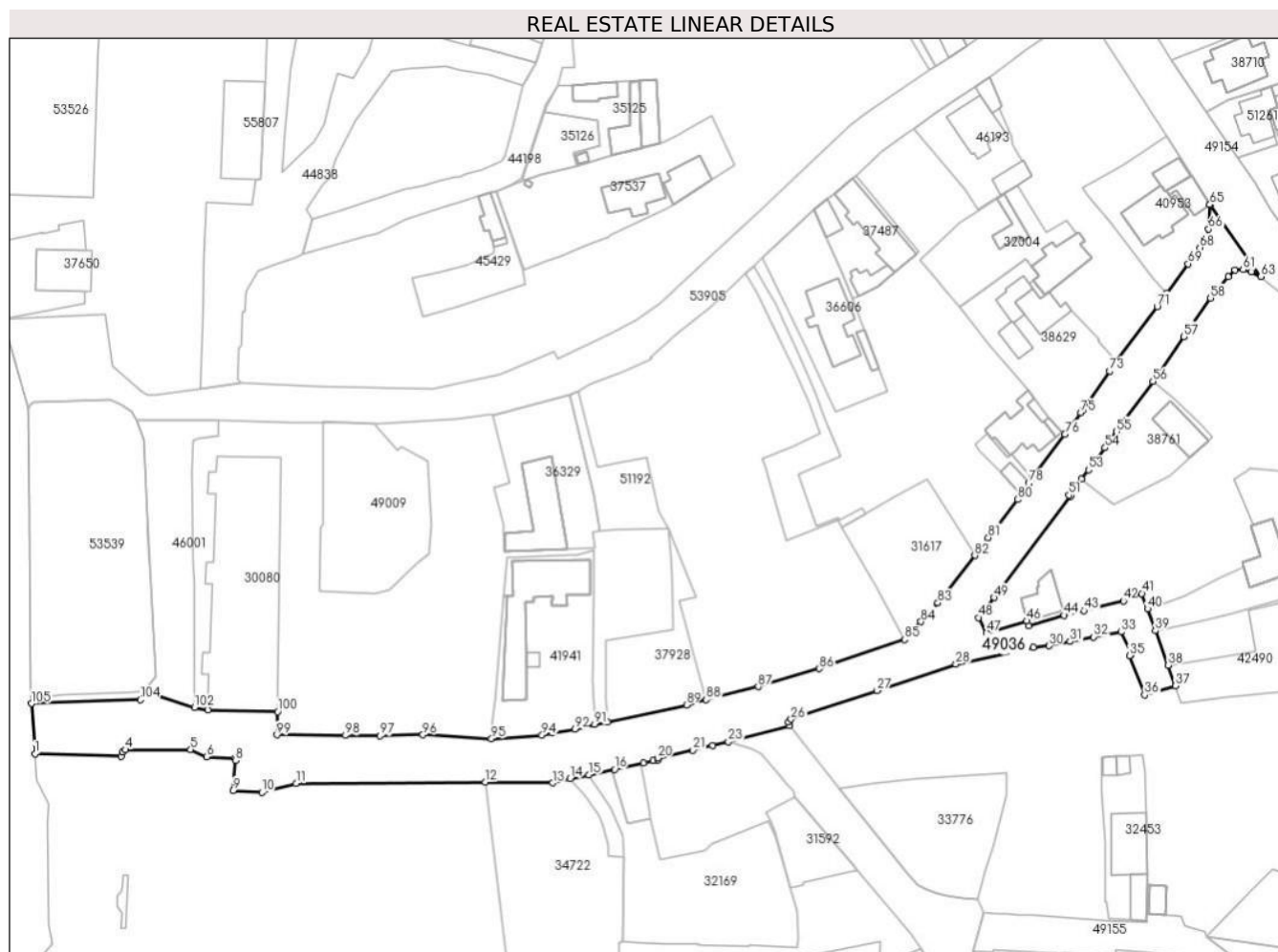

## Land related data

Item no.	Usage category	Land within the built-up area	Surface (sqm)	Strip land	Lot	Topographical no.	Observations / References
1	road	YES	3,030	-	-	-	

## Segments length

1) The segment length values are obtained from the plan projection.

Start point	End point	Segment length	Start point	End point	Segment length	Start point	End point	Segment length
1	2	17.57	2	3	0,905	3	4	0,771
4	5	13,322	5	6	3,596	6	7	5,712
7	8	0,567	8	9	6,156	9	10	5,927
10	11	7,226	11	12	38.63	12	13	13,727
13	14	3,641	14	15	3.95	15	16	5.33
16	17	6,001	17	18	2,115	18	19	1,004
19	20	0,298	20	21	7,384	21	22	4,063

Start point	End point	Segment length	Start point	End point	Segment length	Start point	End point	Segment length
22	23	3,354	23	24	12.91	24	25	0,754
25	26	0,786	26	27	18.49	27	28	16,954
28	29	16,153	29	30	3,264	30	31	4,361
31	32	4,922	32	33	5,647	33	34	4,927
34	35	0,561	35	36	8,543	36	37	6,582
37	38	4,499	38	39	7,531	39	40	4,727
40	41	3,323	41	42	4,067	42	43	8,275
43	44	4,154	44	45	7,604	45	46	1.05
46	47	8,585	47	48	3.53	48	49	5,204
49	50	25.87	50	51	0,404	51	52	4,094
52	53	2,408	53	54	5,633	54	55	4,082
55	56	12.61	56	57	11,088	57	58	9,598
58	59	5.7	59	60	1,931	60	61	1,662
61	62	1,734	62	63	2,164	63	64	17,983
64	65	0,108	65	66	4,971	66	67	2,056
67	68	2,113	68	69	4,097	69	70	7,564
70	71	3,227	71	72	13,869	72	73	2,501
73	74	9,671	74	75	0,689	75	76	5,458
76	77	11,188	77	78	1,157	78	79	2,821
79	80	1,212	80	81	9,872	81	82	4.55
82	83	12,274	83	84	5,157	84	85	4,938
85	86	18,431	86	87	12,969	87	88	10.94
88	89	4,157	89	90	16,582	90	91	2,601
91	92	4,177	92	93	4,763	93	94	2,042
94	95	10,339	95	96	14,007	96	97	8,771
97	98	7.03	98	99	13,975	99	100	4,733
100	101	14,208	101	102	2,832	102	103	10,873
103	104	2,035	104	105	22,217	105	1	10,271

\*\* Segment lengths are determined in the Stereo 70 projection plane and are rounded to 1 millimeter.

\*\*\* The distance between the points is made up of cumulative segments that are smaller than the value of 1 millimeter.